



# MIRAB INDUSTRIAL VALVES

No.: NSF-50-200-10

## Swing Non-Return Valve Data Sheet

Rev.: 00 , Date: Jan 2023

Valve Type	Check Valve (Non-Return)	Hydrostatic Test	Acc. to DIN EN 12266-1/ API Std. 598/ ISO 5208 Body Test: @ 1.5*PN, Seat Test @ 1.1*PN
Valve Features	Swing Disc Soft Sealing (Resilient seated) Minimum Pressure Drop Horizontal or Vertical Installation Bolted Cover Applicable in Low Pressure (0.1 bar)	Coating System	Electrostatic Epoxy Powder, RAL 5005 Min DFT 250 micron (Food Grade)
Application	Backflow Prevention		
Fluid	Raw water, Drinking water, Waste water, Non-Corrosive Fluids and Gas		
End Connection type	Flanged, RF		
Connection Standard	DIN EN 1092-2 (DIN 2501) PN10/ PN16		
Valve Size Range	DN 50 ~ DN 200 (NPS 2 ~ NPS 8)		
Body Rating	Up to 16 bar		
Temperature Rating	Up to 70 °C		
Design Std.	Mirab Std.		
Face to Face Std.	DIN EN 558-1 Series 48 (DIN 3202-F6)		
Body & Cover	Ductile Iron DIN EN 1563 GJS-400-15 (GGG40)		
Disc	Ductile Iron DIN EN 1563 GJS-400-15 (GGG40)		
Body seat	Weld Overlay AWS 5.9 ER308/ 1.4301		
Disc Seat	EPDM Rubber		
Disc Pin	Stainless Steel ASTM A276 Type 420 (1.4021)		

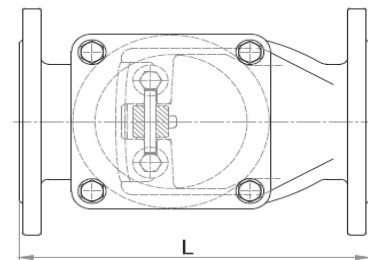
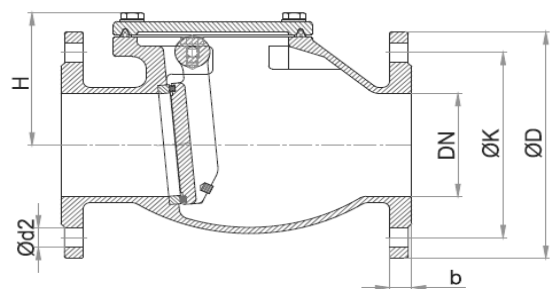

### Dimension:



DN mm	PN bar	L mm	ØD mm	ØK mm	b mm	Ød2 mm	n	H mm	Weight kg
50	10,16	200	165	125	19	19	4	77	8.5
65	10,16	240	185	145	19	19	4	90	11
80	10,16	260	200	160	19	19	8	109	15
100	10,16	300	220	180	19	19	8	130	20.5
125	10,16	350	250	210	19	19	8	139	27
150	10,16	400	285	240	19	23	8	163	39
200	10	500	340	295	20	23	8	200	86
	16						12		