

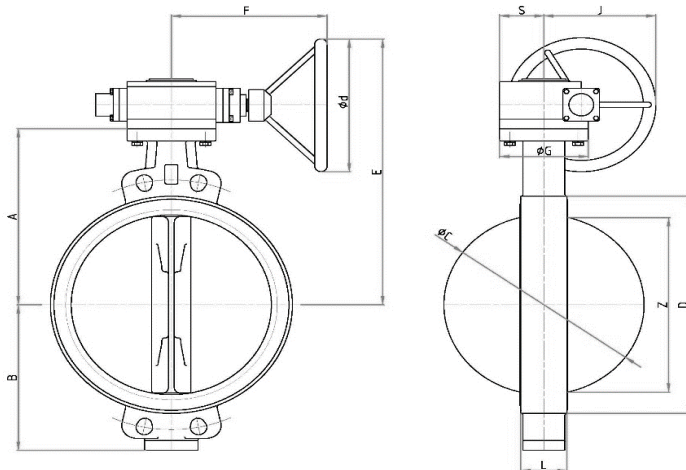

<b>Valve Type</b>	Butterfly Valve Wafer Type	<b>Hydrostatic Test</b>	Acc. to DIN EN 12266-1/ API Std. 598/ ISO 5208 Body Test: N/A, Seat test @ 1.1*PN
<b>Valve Features</b>	Concentric type Bi-Directional Sealing Tight Shut-Off Closure K & KV Parameters Acc. to Mirab catalogue Gasket for installation is not required due to Renewable U-Shape Elastomer liner on valve body	<b>Coating System</b>	Electrostatic Epoxy Powder, RAL 5005 Min DFT 150 micron (Food Grade)
<b>Application</b>	On-Off (Isolating)	<b>Actuator</b>	Gearbox, Worm type Part-Turn, Open-Close Duty With 0-90° Indicator Ductile Iron Epoxy Coated With Open/ Close End Stop Adjustable Swing Range up to 90° Flange Acc. to EN ISO 5211 Closed Clockwise rotation
<b>Fluid</b>	Raw water, Drinking water, Non-Corrosive Liquid and Gas		
<b>End Connection type</b>	Wafer type (To be installed Between Flanges)		
<b>Connection Standard</b>	DIN EN 1092 (DIN 2501) PN6/PN10/PN16 ASME/ ANSI B16.5 CLASS 150		
<b>Valve Size Range</b>	DN 450 ~ DN 600 (NPS 18 ~ NPS 24)		
<b>Body Rating</b>	Up to 16 Bar		
<b>Temperature Rating</b>	Up to 70 °C		
<b>Design Std.</b>	DIN EN 593 & API Std. 609 Cat. A		
<b>Face to Face Std.</b>	DIN EN 558-1 Series 20 & API Std. 609 Cat. A		
<b>Body</b>	Ductile Iron DIN EN 1563 GJS-400-15 (GGG40)		
<b>Disc</b>	Ductile Iron DIN EN 1563 GJS-400-15 (GGG40)		
<b>Body seat (Liner)</b>	EPDM Rubber		
<b>Shaft</b>	Stainless Steel ASTM A276 Type 420 (1.4021)		
<b>Shaft Sealing</b>	O-Ring (NBR)		
<b>Bushing</b>	Steel-PTFE/ C95200		
<b>End Cap</b>	Ductile Iron		



Dimension:

DN mm	L mm	ØC mm	Z mm	A mm	B mm	D mm	E mm	F mm	ØG mm	J mm	d mm	S mm	Weight Kg
450	114	442.5	427.5	395	335	516	652	334	175	280	400	120	101
500	127	492.5	484.2	437	377	574	712	416	210	298	500	105	146
600	154	584	562.3	498	440	675	802	465	210	350	500	150	PN6,10=213
								537					PN16=221



DN mm	PN 06			PN 10			PN 16			Class150		
	ø k mm	d mm	n	ø k mm	d mm	n	ø k mm	d mm	n	ø k mm	d mm	n
450	550	23	16	565	28	20	585	31	20	577.9	31.8	16
500	600	23	20	620	28	20	650	34	20	635	31.8	20
600	705	28	20	725	31	20	770	37	20	749.3	35	20